

Quick Start Guide and Terms & Conditions

Read this document before operating the mobile device, accessories, or software (defined collectively and individually as the "Product") and keep it for future reference. This document contains important Terms and Conditions. Electronic acceptance, opening the packaging, use, or retention of the Product constitutes acceptance of these Terms and Conditions.

SAMSUNG Galaxy Watch5 Galaxy Watch5 Pro

IP68 Rated



Printed in Korea
GH68-54739A Rev 1.3



Need support?

Register your device for benefits like service & support, warranty info, the latest news, and more



Scan the code or visit samsung.com/us/support/register-product

Samsung Care+

Coverage for repairs and dedicated 24/7 support
samsung.com/us/support/samsung-care-plus

Get help

samsung.com/us/support
youtube.com/samsungcare

Get to know your device

Galaxy Watch5
Galaxy Watch5 Pro



Power/Home On/Off
Back



Power/Home On/Off
Back

Use caution to avoid damaging this product. Do not expose the product to humidity, solvents or high temperatures; doing so may stain, wrinkle, discolor or distort it.

Get started

Charge the battery

Your device is powered by a rechargeable battery. To charge, use the included wireless charger and a USB Type-C adapter (sold separately). Use only Samsung-approved chargers and accessories. Damage caused by use of accessories that are not approved by Samsung may not be covered by warranty.

Center the device on the wireless charger.

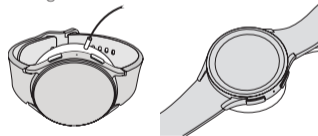

Turn the device on

Press and hold the Power/Home key for a few seconds.

Get connected

Download the **Galaxy Wearable app** to connect your device and smartphone.

Activate your Galaxy Watch

The R905U, R915U and R925U are 4G LTE-enabled. Get texts, make and receive calls, even when you leave your phone behind. Consult your wireless carrier for details about activation.

Band adjustment tips

D Buckle band (included with some models)

Open the magnetic buckle.



Open the clasp and slide the end of the band.

Note: Gently pull the end of the strap to assist in opening the clasp.

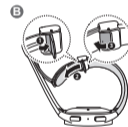

Close the buckle.



APPROVED FIRMWARE VERSIONS

This device will only operate with firmware versions that have been approved for use by your wireless carrier and the device manufacturer. If unauthorized firmware is placed on the device it will not function.

SAFEGUARDING DEVICES

We encourage customers to take appropriate measures to secure their devices and invite them to take advantage of the features available on this device to help secure it from theft and/or other unauthorized access and use. This device has a locking function (e.g., user-defined codes or patterns) that can serve as a first line of defense against unauthorized use or access to stored information. Preloaded security applications that allow customers to track or locate misplaced devices can be found on several devices. Lost or stolen devices should be immediately reported to your wireless carrier so that proper measures can be taken to protect accounts. For additional information, visit your wireless carrier's Privacy Policy.

Terms & Conditions

Important legal information

Read this document before operating the mobile device, accessories, or software (defined collectively and individually as the “Product”) and keep it for future reference. This document contains important Terms and Conditions. Electronic acceptance, opening the packaging, use, or retention of the Product constitutes acceptance of these Terms and Conditions.

You can obtain a copy of the complete Terms and Conditions and Samsung Standard One-year Limited Warranty by contacting Samsung at the address or phone number provided in this document.

Dispute Resolution Agreement - This Product is subject to a binding Dispute Resolution Agreement, which includes arbitration terms, between you and SAMSUNG ELECTRONICS AMERICA, INC. (“Samsung”). You can opt out of the agreement within 30 calendar days of the first consumer purchase by emailing optout@sea.samsung.com or calling 1-800-SAMSUNG (726-7864) and providing the applicable information.

The Dispute Resolution Agreement, Standard One-year Limited Warranty, End User License Agreement (EULA), and additional Health, Safety and Device care information, including:

- Device Temperature
- Samsung Knox security platform
- Maintaining Dust and Water Resistance (IP rating)
- Location, Navigation, GPS and AGPS
- Wireless Emergency Alerts (WEA)

are available at:

English:

www.samsung.com/us/support/legal/mobile

Spanish:

www.samsung.com/us/support/legal/mobile-sp

This information is also on the device:

Settings > **About phone** or **About device** or **About tablet** or **About watch** > **Legal information** > **Samsung legal** or, search for “Legal”

You can view the Federal Communications Commission (FCC) certification, if applicable, by opening **Settings** > **About phone** or **About device** or **About tablet** or **About watch** > **Status** or **Status information**

Specific Absorption Rate (SAR) certification information

For information about SAR, visit:

- www.fcc.gov/general/radio-frequency-safety-0
- www.fcc.gov/encyclopedia/specific-absorption-rate-sar-cellular-telephones
- www.samsung.com/sar

Samsung mobile products and recycling

WARNING! Never dispose of batteries in a fire because they may explode. Do not disassemble, crush, puncture, heat, burn or reuse. For more recycling information, go to our website: www.samsung.com/recycling or call 1-800-SAMSUNG.

FCC Part 15 Information and Notices

This device complies with part 15 of the FCC Rules. Operation is subject to conditions: (1)

This device may not cause harmful interference, and (2) this device must accept any interference received, including interference that may cause undesired operation. Operate devices that support power sharing at least 8 inches/20 cm away from your body.

Emergency calls

Emergency calls may not be possible on all wireless mobile device networks or when certain network services and/or mobile device features are in use. Check with local service providers. If certain features are in use (e.g. call blocking) you may first need to deactivate those features before you can make an emergency call.

Exposure to Radio Frequency (RF) signals

For information, go to www.samsung.com/us/support/legal/mobile > **Health and Safety Information** > **Exposure to Radio Frequency (RF) signals**

WARNING! Your Samsung device contains magnets. Keep it away from credit cards and devices that may be affected by magnets. Keep your Samsung device more than 6 in./15cm away from medical devices. If you suspect interference with a medical device, stop using your Samsung device and consult your medical provider.

Samsung Electronics America, Inc.
85 Challenger Road
Ridgefield Park, New Jersey 07660
Phone: 1-800-SAMSUNG (726-7864)
Internet: www.samsung.com

Devices and related software not intended to diagnose, cure, mitigate, treat or prevent disease or other health conditions.

© 2022 Samsung Electronics America, Inc. Samsung & Samsung Galaxy are registered trademarks of Samsung Electronics Co., Ltd. Other company and product names mentioned herein may be trademarks of their respective owners. Screen images simulated. Appearance of device may vary. Images shown are for reference only. If you use a screen protector, make sure it allows for use of touch-screen features.