

ROAV

ROAV

Model: R5141
51005000857 V02

Owner's Manual
Roav VIVA

If Roav VIVA cannot fit into your car's cigarette lighter socket, just return Roav VIVA and we will be happy to give you a full refund. Please contact our customer service center:



support@goroav.com



+1 (800) 988 7973 (US) Mon-Fri 9:00 - 17:00 (PT)
+44 (0) 1604 936200 (UK) Mon-Fri 6:00 - 11:00 (GMT)
+49 (0) 69 9579 7960 (DE) Mon-Fri 6:00 - 11:00



Live Chat on Roav app and website

Table of Content

Important Safety Instructions	01
Introduction	04
Using Roav VIVA	08
Pairing Roav VIVA with Your Car's Bluetooth Stereo	09
Using Roav VIVA with Alexa	10
Charge Your Devices	11
Specifications	11
Notice	12
Trademark	13
Customer Service	14
Troubleshooting	15

Important Safety Instructions

SAVE THESE INSTRUCTIONS

- This manual contains important safety and operating instructions for the car charger of Roav VIVA (Model R5141).

Please read and understand all instructions before using this product. If damage is caused by failure to follow the instructions, the warranty does not apply.

- Read all instructions and cautionary markings before using this product.
- Do not expose to rain, moisture, or snow.
- Use of an attachment is not recommended or sold by the manufacturer may result in a risk of fire, electric shock, or injury to persons.
- Do not operate this car charger if it has received a sharp blow, been dropped, or otherwise damaged in any way; take it to a qualified service person.
- Do not disassemble this car charger; take it to a qualified service person when service or repair is required. Incorrect reassembly may result in a risk of electric shock or fire.
- To reduce risk of electric shock, unplug this car charger before attempting any maintenance or cleaning. Turning off controls will not reduce this risk.
- To reduce risk of fire or electric shock, do not interconnect

- output terminations.
- Avoid long exposure to direct sunlight, which may cause damage to the device.
- Exposing this product to open flames may cause it to explode.
- Do not use this product in strong magnetic fields.
- Use a dry, soft lint-free cloth to clean. Do not use any corrosive cleaner or oil to clean.
- CAUTION - For continued protection against risk of fire, replace only with the same type and ratings of fuse, fuse rating is 32V DC / 7A.
- Always obey traffic laws and pay attention to the road. Do not attempt to use this device while driving, as some features are limited while the vehicle is in motion. Failure to pay full attention to the operation of your vehicle could result in death, serious injury or property damage. You assume total responsibility and risk for using this device.

Note: Please contact our customer service center if you cannot plug Roav VIVA into your car's cigarette lighter socket.

Consignes de sécurité importantes

CONSERVEZ CES

CONSIGNES

- Ce manuel contient d'importantes instructions de sécurité et d'utilisation relatives au chargeur de voiture modèle R5141.

Veuillez lire et comprendre toutes les instructions avant d'utiliser ce produit. Si le non-respect des instructions entraîne des dommages, la garantie ne s'appliquera pas.

- Lisez toutes les instructions et les mises en garde avant d'utiliser ce produit.
- Ne pas exposer à la pluie, l'humidité ou la neige.
- L'utilisation d'un accessoire non recommandé ou vendu par le fabricant peut entraîner un risque d'incendie, de choc électrique lessure.
- Ne pas utiliser ce chargeur de voiture s'il a reçu un coup violent, s'il est tombé ou s'il a été endommagé de quelque façon que ce soit ; l'apporter à un technicien qualifié.
- Ne pas démonter ce chargeur de voiture ; l'apporter à un technicien qualifié lorsqu'une réparation est nécessaire. Un réassemblage incorrect peut entraîner un risque d'électrocution ou d'incendie.
- Pour réduire les risques d'électrocution, débrancher le chargeur de voiture avant d'effectuer toute opération d'entretien ou de nettoyage. La désactivation des commandes ne réduit pas ce risque.
- Pour réduire les risques d'incendie ou d'électrocution, ne pas interconnecter les terminaisons de sortie.
- Éviter toute exposition prolongée à la lumière directe du soleil, qui pourrait endommager l'appareil.
- L'exposition de ce produit à des flammes nues peut provoquer son explosion.
- Ne pas utiliser ce produit dans des champs magnétiques puissants.
- Utiliser un chiffon sec, doux et non pelucheux pour le

nettoyage. Ne pas utiliser de nettoyeur corrosif ni d'huile.

- **ATTENTION** - Pour une protection continue contre les risques d'incendie, ne remplacer le fusible que par un fusible de même type et de même spécification. Le fusible utilisé est de 32V DC / 7A.

Introduction

Features

- Supports voice control via the Amazon Alexa voice service.*
 - 2-port USB PowerIQ car charger by ANKER.
 - Voice Activated Navigation.
 - Hands Free Calls And Music.
- * Read the Skills Cards to find more commands to ask Alexa.

What's Included

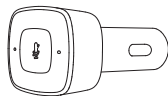

At a Glance

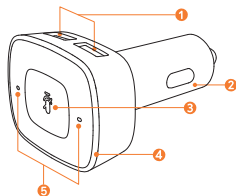

- 1 USB charging port
- 2 Car charger adaptor
- 3 / Multifunction button
- 4 LED ring-light indicator
- 5 Microphones

Button Controls

Alexa Voice Service Mode

Wake up



Press

Mute / Unmute microphone



Long press for 1 second

Timer & Alarm Mode

Stop



Press

LED Indications

Status	LED Ring-Light Indicator
--------	--------------------------

Power on	Lights up blue with a circulating cyan light.
Ready to pair	Pulses blue for 5 minutes, glows orange for 30 seconds, and then fades out if a smartphone is not detected.
No connection	No light is emitted.
Connected	Glows blue for 5 seconds and then dims to 50% brightness.
Notification alert	New notification: yellow light glows once. Unread notifications: yellow light pulses slowly for 5 seconds.
Activated & Listening	Cyan light expands from the upper-left to the bottom-right corner.
Thinking	2 cyan lights rotate.
Speaking	Pulses cyan.
Finished	Cyan light dims from the bottom-right to the upper-left corner.
Incoming call	Pulses green.
During call	Lights up green.
Alarm & Timer	Light alternately pulses blue and cyan.
Volume	Volume up: Ring-light indicator turns white in a clockwise direction. Volume down: Ring-light indicator light fades out in a counterclockwise direction.
Microphone muted	LED ring-light and microphone icon turn red.
Firmware upgrading	Circulates green.
Service is not available/ Wireless network is unstable	Pulses orange.

Using Roav VIVA

- 1 Plug Roav VIVA into your vehicle's cigarette lighter socket and then start the engine; the LED ring-light indicator will shine blue with a circulating cyan light.

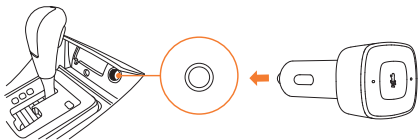

- 2 Download the Roav VIVA app from the App Store (smartphones running iOS 10.2 or higher) or Google Play (smartphones running Android 5.0 or higher).



- 3 Open the app and create a user account. For the best user experience, enable all the access requests that ROAV VIVA might need.
- 4 Select Roav VIVA, then make the connection.

Note: Do not pair your Roav VIVA through your smartphone's Bluetooth settings menu in advance.

Pairing Roav VIVA with Your Car's Bluetooth Stereo

Follow the on-screen instructions in the Roav VIVA app to complete the Bluetooth pairing process.

- 1 Use the Roav VIVA app to connect your Roav VIVA charger. Once connected, the LED ring indicator light will shine blue.
- 2 Connect to your car's stereo system.

Note: You can also connect your smartphone directly to your car stereo's Aux-In port by using a 3.5mm audio cable.

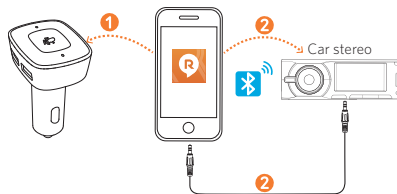

Using Roav VIVA with Alexa

Roav VIVA comes with a voice service feature. You can play music, get navigation directions, manage everyday tasks, and easily control smart devices around you by using your voice.

- 1 Follow the on-screen instructions in the Roav VIVA app to login with your Amazon account.
- 2 To activate the voice service feature, say the wake word "Alexa" or press .

Alexa,

or

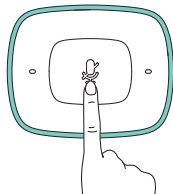

- ▶ Roav VIVA will respond instantly.
- ▶ Read the **Skills Cards** to learn more Alexa commands.
- ▶ Visit alexa.amazon.com/ for more information, or download Amazon Alexa app on your iOS/Android device.
- ▶ To enable more skills on your device, please visit the "**Skills**" page on alexa.amazon.com/.

09

Charge Your Devices

Roav VIVA contains dual USB charging ports. You can charge two devices at the same time with a maximum output of 5V/4.8A.

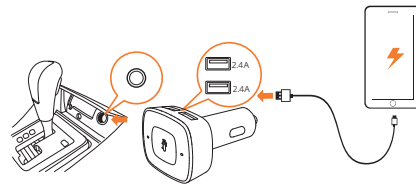

Note: Remove Roav VIVA from your vehicle's cigarette lighter socket when the engine is turned off. The battery of Roav VIVA can last for up to 15 days in standby mode.

Specifications

Specifications are subject to change without notice.

DC input: 12V - 24V
Power output: 5V  4.8A Max
Bluetooth version: V4.1
Bluetooth transmission distance: 10m / 33ft
Operating temperature range: -20°C to 40°C / -4°F to 104°F
Storage temperature range: -40°C to 85°C / -40°F to 185°F

10

Notice



This product complies with the radio interference requirements of the European Community.

BT Operating Frequency Range: 2402-2480 MHz



This product is designed and manufactured with high quality materials and components, which can be recycled and reused.



This symbol means the product must not be discarded as household waste, and should be delivered to an appropriate collection facility for recycling. Proper disposal and recycling helps protect natural resources, human health and the environment. For more information on disposal and recycling of this product, contact your local municipality, disposal service, or the shop where you bought this product.



FCC Statement

This device complies with Part 15 of the FCC Rules. Operation is subject to the following two conditions: (1) this device may not cause harmful interference, and (2) this device must accept any interference received, including interference that may cause undesired operation.

Warning: Changes or modifications not expressly approved by the party responsible for compliance could void the user's authority to operate the equipment.

Note: This equipment has been tested and found to comply with the limits for a Class B digital device, pursuant to Part 15 of the FCC Rules. These limits are designed to provide reasonable protection against harmful interference in a residential installation.

This equipment generates uses and can radiate radio frequency energy and, if not installed and used in accordance with the instructions, may cause harmful interference to radio communications. However, there is no guarantee that interference will not occur in a particular installation. If this equipment does cause harmful interference to radio or television reception, which can be determined by turning the equipment off and on, the user is encouraged to try to correct the interference by one or more of the following measures: (1) Reorient or relocate the receiving antenna. (2) Increase the separation between the equipment and receiver. (3) Connect the equipment into an outlet on a circuit different from that to which the receiver is connected. (4) Consult the dealer or an experienced radio/TV technician for help.

FCC Radio Frequency Exposure Statement

The device has been evaluated to meet general RF exposure requirements. The device can be used in fixed/mobile exposure condition. The min separation distance is 20cm.

11

Trademark



Amazon, Alexa and all related logos are trademarks of Amazon.com, Inc. or its affiliates.

Apple and the Apple logo are trademarks of Apple Inc., registered in the U.S. and other countries. App Store is a service mark of Apple Inc., registered in the U.S. and other countries.

Google Play and the Google Play logo are trademarks of Google Inc.

"Android" is a registered trademark of Google Inc. in the United States and other countries.

"iOS" is a registered trademark of Apple Inc. in the United States and other countries.



The Bluetooth® word mark and logos are registered trademarks owned by Bluetooth SIG, Inc.

Other trademarks and trade names are those of their respective owners.

12

Customer Service



12-Month Limited Warranty



Lifetime Technical Support



support@goroav.com



+1 (800) 988 7973 (US) Mon-Fri 9:00 - 17:00 (PT)
+44 (0) 1604 936200 (UK) Mon-Fri 6:00 - 11:00 (GMT)
+49 (0) 69 9579 7960 (DE) Mon-Fri 6:00 - 11:00



Live Chat on Roav app and website



@GoRoav



@GoRoav

Anker Innovations Limited
Room 1318-19, Hollywood Plaza, 610 Nathan Road, Mongkok,
Kowloon, Hong Kong

© Anker Innovations Limited. All rights reserved. ROAV and the ROAV logo are trademarks of Anker Innovations Limited, registered in the United States and other countries.

Troubleshooting

1. My smartphone is unable to connect to the car stereo via Bluetooth.

- ▶ Make sure the Bluetooth connection of your car's stereo is enabled. Is the car stereo able to connect to your smartphone when Roav VIVA is not in use? If yes, connect the car stereo first then connect F4 through the Roav VIVA app.
- ▶ Restart the Bluetooth connection on your smartphone and, try again.
- ▶ Enable Airplane mode on your smartphone and then try again.
- ▶ Restart your smartphone.

2. My car's stereo doesn't play any sound when the Alexa Voice System is broadcasting.

- ▶ Make sure your smartphone is connected to the car stereo.
- ▶ Make sure you have Bluetooth Media chosen on your vehicle stereo.
- ▶ Make sure the volume control on your smartphone is switched on.
- ▶ Make sure the volume control of the car stereo is switched on.

