

ROAV

Owner's Manual Roav Smart Car-Charger Spectrum

Safety Instructions

Please read and understand all instructions before using this product. If damage is caused by failure to follow the instructions, the warranty does not apply.

- Keep these instructions.
- Do not drop, puncture or disassemble this product.
- This product shall not be exposed to dripping or splashing liquids.
- Avoid long exposure to direct sunlight, which may cause damage to this product.
- Exposing this product to open flames may cause explosion.
- Do not use this product in strong magnetic fields.
- Use a clean, soft cloth to clean. Do not use any corrosive cleaner/oil to clean.

Introduction

Features

- USB PowerIQ car charger by ANKER.
- USB Quick Charge 3.0 car charger by ANKER.
- Companion Roav Spectrum app with car battery monitor and car locator.
- Customize the colors of LED ring indicator via Roav Spectrum app to indicate different status.

What's Included

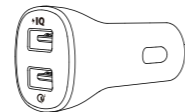

At a Glance

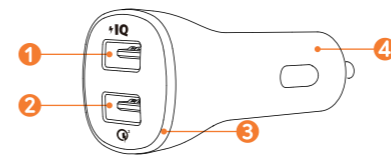

- 1 USB charging port (PowerIQ 2.0)
- 2 USB charging port (Quick Charge 3.0 + PowerIQ 2.0)
- 3 LED ring indicator
- 4 Car charger adapter

Get Started

- 1 Download the Roav Spectrum app from the App Store (iOS devices) or Google Play (Android devices).



- 2 Plug Roav Smart Car-Charger Spectrum into your vehicle's cigarette lighter socket. Start the engine and Roav Smart Car-Charger Spectrum will automatically power on.

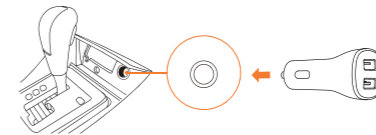

- 3 Open the Roav Spectrum app and follow the instructions to connect the device via Bluetooth. Enable Bluetooth on your smartphone and search for Bluetooth devices available. Select "Roav Spectrum_XXX" and connect. Once connected, the LED ring indicator will turn blue by default.

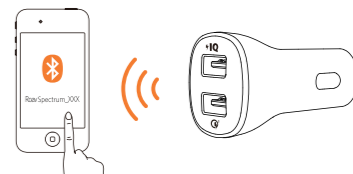

- 4 Now you can locate your car, set a parking timer, check your vehicle's car battery, customize the colors of LED ring indicator, and find out more via Roav Spectrum app.



Model: R5121
51005000734 V01

Charge Your Devices

The Roav Smart Car-Charger Spectrum contains dual USB charging ports. You can charge two devices at the same time with maximum output power of 30W.

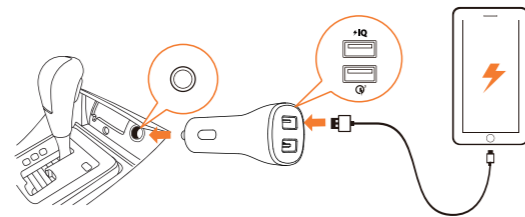

Charge Your Devices

Specifications are subject to change without notice.

DC input: 12V-24V

Standard output: 5V = 2.4A

Quick Charge 3.0 output: 3.6V-6.5V = 3A, 6.5V-9V = 2A, 9V-12V = 1.5A

Total Wattage: 30W

Bluetooth version: V 4.1

Operating temperature range: -4°F to 104°F / -20°C to 40°C

Storage temperature range: -40°F to 185°F / -40°C to 85°C

Notice

FCC Statement

This device complies with Part 15 of the FCC Rules. Operation is subject to the following two conditions: (1) this device may not cause harmful interference, and (2) this device must accept any interference received, including interference that may cause undesired operation.

Warning: Changes or modifications not expressly approved by the party responsible for compliance could void the user's authority to operate the equipment.

Note: This equipment has been tested and found to comply with the limits for a Class B digital device, pursuant to Part 15 of the FCC Rules. These limits are designed to provide reasonable protection against harmful interference in a residential installation.

This equipment generates uses and can radiate radio frequency energy and, if not installed and used in accordance with the instructions, may cause harmful interference to radio communications. However, there is no guarantee that interference will not occur in a particular installation. If this equipment does cause harmful interference to radio or television reception, which can be determined by turning the equipment off and

on, the user is encouraged to try to correct the interference by one or more of the following measures: (1) Reorient or relocate the receiving antenna. (2) Increase the separation between the equipment and receiver. (3) Connect the equipment into an outlet on a circuit different from that to which the receiver is connected. (4) Consult the dealer or an experienced radio/TV technician for help.

FCC Radio Frequency Exposure Statement

The device has been evaluated to meet general RF exposure requirements. The device can be used in fixed/mobile exposure condition. The min separation distance is 20cm.



Qualcomm Quick Charge is a product of Qualcomm Technologies, Inc. Qualcomm and Quick Charge are trademarks of Qualcomm Incorporated, registered in the United States and other countries. All Qualcomm Incorporated trademarks are used with permission.



Apple and the Apple logo are trademarks of Apple Inc., registered in the U.S. and other countries. App Store is a service mark of Apple Inc., registered in the U.S. and other countries. Google Play and the Google Play logo are trademarks of Google Inc.

Customer Service

18-month limited warranty

Lifetime technical support

support@goroav.com

+1(800) 988 7973 (US) Mon-Fri 9:00-17:00 (PT)

@GoRoav @GoRoav

© Anker Technology Co., Limited. All rights reserved. ROAV and the ROAV logo are trademarks of Anker Technology Co., Limited, registered in the United States and other countries. All other trademarks are the property of their respective owners.